

**MOUNTAIN IRON CITY COUNCIL MEETING
COMMUNITY CENTER
MOUNTAIN IRON ROOM
TUESDAY, FEBRUARY 19, 2013 - 6:30 P.M.
A G E N D A**

- I. Roll Call
- II. Consent Agenda
 - A. Minutes of the February 4, 2013, Regular Meeting (#1-10)
 - B. Receipts
 - C. Bills and Payroll
 - D. Communications (#38-40)
- III. Public Forum
- IV. Committee and Staff Reports
 - A. Mayor's Report
 - B. City Administrator's Report
 - C. Interim Public Works Director's Report
 - D. City Attorney's Report
 - E. Sheriff's Department Report
 - F. City Engineer's Report
 - G. Planning and Zoning Commission
 - 1. Preliminary Plat – Energy Park (#11-13)
 - H. Personnel Committee
 - 1. Firefighter Pay (#14)
 - I. Liaison Reports
- V. Unfinished Business
- VI. New Business
 - A. Resolution Number 05-13 Accepting Feasibility Report (#15-33)
 - B. Resolution Number 06-13 Calling for Feasibility Report (#34-35)
 - C. Authorization to Seek Bids (#36)
- VII. Communications (#38-40)
- VIII. Announcements
- IX. Closed Meeting (#37)
- X. Adjourn

MINUTES
MOUNTAIN IRON CITY COUNCIL
FEBRUARY 4, 2013

Mayor Skalko called the City Council meeting to order at 6:32 p.m. with the following members present: Joe Prebeg, Jr., Susan Tuomela, Tony Zupancich, Alan Stanaway, and Mayor Gary Skalko. Also present were: Craig J. Wainio, City Administrator; Jill M. Clark, Municipal Services Secretary; Michael Downs, Interim Director of Public Works; Rodney Flannigan, Benchmark Engineering; Sally Peterangelo, Librarian; John Backman, Sergeant; Joe Buria, Fire Chief; and Jeremy Waldron, Assistant Fire Chief.

It was moved by Skalko and seconded by Prebeg that the consent agenda be approved as follows:

1. Add the following item to the agenda:

VI. C. Resolution #04-13, authorizing the submittal of a grant application

2. Approve the minutes of the January 22, 2013, regular meeting as submitted.
3. That the communications be accepted and placed on file and those requiring further action by the City Council be acted upon during their proper sequence on the agenda.
4. To acknowledge the receipts for the period January 16-31, 2013, totaling \$256,461.13, (a list is attached and made a part of these minutes).
5. To authorize the payments of the bills and payroll for the period January 16-31, 2013, totaling \$256,658.47, (a list is attached and made a part of these minutes).

The motion carried unanimously.

No one spoke during the public forum.

The Mayor reported on the following:

- Mesabi Daily News “unsigned Onions”. He said that there was an unsigned onion in the newspaper stating that the City’s Fire Chief no longer lived in the City of Mountain Iron. The Mayor assured the residents of the City that the Fire Chief does live in the City.
- City Hall/Community Center Solar Panels. The City installed solar panels behind the building last Summer. The panels were generating power last August. He said that additional information on the power generated by the solar panels was on the City’s web site, www.mtniron.com
- Acknowledgements. He acknowledged the passing of the oldest male resident in Mountain Iron, Hugo Johnson, at 100 years old. Condolences were expressed to the family.

It was moved by Zupancich and seconded by Tuomela to authorize the Municipal Services Secretary to attend the Minnesota Municipal Clerks and Finance Officers Association Conference from March 19-22, 2013, in St. Cloud at a cost not to exceed \$760. The motion carried.

The City Administrator reported on the following:

- Skating Rinks. He informed the Council that the rinks were open in South Grove and West Virginia and that a sheet of ice was available to skate on in the Ann's Acres Park, contrary to the onions in the newspaper.
- MediaCom Coverage. He thanked MediaCom for airing the Saint Cloud State Huskies on television. He further stated that they are number one in the WCHA.

It was moved by Zupancich and seconded by Stanaway to approve Contract #2012-007647 with Saint Louis County for the collection of residential and commercial recyclable materials, (a copy is attached and made a part of these minutes). The motion carried.

The Library Director reported on the following:

- January, 2013 Report. She submitted her monthly report to the Council.
- Special Events. She said that she is working on plans for a small winter carnival on March 2, 2013, in South Grove, which would include a sleigh ride, games on the ice, and concessions.
- Concerts. She advised the Council that there would be three concerts coming up in March paid for by the Legacy Grant.

It was moved by Zupancich and seconded by Tuomela to authorize City Staff to purchase the 1994 Saulsbury/Spartan Custom Rescue Pumper at a cost of \$76,000 and an additional \$4,000 for delivery fees. The motion carried unanimously on a roll call vote.

It was moved by Stanaway and seconded by Prebeg to accept the recommendation of the Public Health and Safety Board and the Personnel Committee and re-appoint Jeremy Waldron as Assistant Chief and William Copeland as Captain with their terms to expire on December 31, 2015. The motion carried.

It was moved by Prebeg and seconded by Tuomela to accept the recommendation of the Parks and Recreation Board and advertise for coaches for the summer programs. The motion carried.

It was moved by Zupancich and seconded by Stanaway to authorize Club Mesabi Incorporated to use Locomotive Park for the 9th Annual Great River Energy Mesabi Trail Tour on August 3, 2013. The motion carried.

It was moved by Prebeg and seconded by Tuomela to accept the recommendation of the Parks and Recreation Board and authorize the following changes to the West Two Rivers Campground policy:

- 1) Change the rental rate of the pavilions from \$35 to \$50
- 2) Change the time at which reservations would be taken to “no reservations would be accepted prior to 9:00 a.m. on March 1st”.
- 3) Change the time frame in which the payment is due in order to reserve a campsite from 10 days to 5 days.

The motion carried.

It was moved by Zupancich and seconded by Stanaway to adopt Resolution Number 03-13, ordering preparation of report on improvement, (a copy is attached and made a part of these minutes). The motion carried.

It was moved by Prebeg and seconded by Tuomela to re-schedule the next regular meeting to Tuesday, February 19, 2013, because of the President’s Day holiday. The motion carried.

It was moved by Stanaway and seconded by Tuomela to adopt Resolution Number 04-13, authorizing the submittal of a safe routes to school infrastructure application to the Minnesota Department of Transportation, (a copy is attached and made a part of these minutes). The motion carried.

It was moved by Skalko and seconded by Zupancich to authorize a contribution of \$500 for the Summer Work Outreach Project with the funds expended from the Charitable Gambling Fund. The motion carried unanimously on a roll call vote.

During the announcements, Councilor Prebeg informed the residents that the 11th Annual Bush Prebeg Memorial Snowmobile Run Fundraiser was scheduled for February 16, 2013, beginning at 8:00 a.m. at B.G.’s in Mountain Iron.

At 7:23 p.m., it was moved by Skalko and seconded by Tuomela that the meeting be adjourned. The motion carried.

Submitted by:



Jill M. Clark, MMC
Municipal Services Secretary

www.mtniron.com

COMMUNICATIONS

1. Summer Work Outreach Project, a letter and brochure requesting donations for 2013.

Summary By Category And Distribution

Category	Distribution	Amount
SPECIAL ASSESSMENTS	SPECIAL ASSESS.-BOND MONEY	448.46
SPECIAL ASSESSMENTS	INTEREST-SP.ASSESS.-BONDS ISSU	247.64
BUILDING RENTALS	BUILDING RENTAL DEPOSITS	1,000.00
BUILDING RENTALS	COMMUNITY CENTER	425.00
UTILITY	UTILITY	150,894.69
FINES	CRIMINAL	1,990.88
MISCELLANEOUS	REIMBURSEMENTS	35,343.77
CHARGE FOR SERVICES	WATER-CHARGE FOR SERVICES	41.18
MISCELLANEOUS	CABLE TV FRANCHISE FEE	6,138.50
CD INTEREST	CD INTEREST 101	35.88
CD INTEREST	CD INTEREST 602	45.99
CD INTEREST	CD INTEREST 603	91.64
CD INTEREST	CD INTEREST 604	140.78
CD INTEREST	CD INTEREST 378	256.02
METER DEPOSITS	ELECTRIC	450.00
MISCELLANEOUS	ASSESSMENT SEARCHES	10.00
MISCELLANEOUS	BLUE CROSS/BLUE SHIELD PAYABLE	33,605.07
LICENSES	ANIMAL	15.00
CHARGE FOR SERVICES	ELECTRIC-CHG FOR SERVICES	10,210.54
TAXES	TAXES RECEIVABLE-DELINQUENT	7,876.06
TAXES	PENALTIES & INTEREST	1,088.69
TAXES	PENALTIES & INTEREST-378 FUND	741.85
TAXES	SPEC ASSESS-FUND 378-DELINQUEN	2,214.58
TAXES	BOND LEVY	2,826.28
TAXES	TAX LEVY	262.33
PERMITS	BUILDING	31.00
MISCELLANEOUS	COCA-COLA RECEIPTS-CITY HALL	29.30
Summary Totals:		<u>256,461.13</u>

Report Criteria:

Check, Check No = 143418-143465

Per	Date	Check No	Vendor No	Payee	Check GL Acct	Amount
02/13	02/06/2013	143418	5007	ASSURANT EMPLOYEE BENEFITS	101-20200	1,084.18
02/13	02/06/2013	143419	10042	AUTO VALUE VIRGINIA	603-20200	51.82
02/13	02/06/2013	143420	30054	BAKER TILLY VIRCHOW KRAUSE LLP	601-20200	4,375.00
02/13	02/06/2013	143421	30017	CARQUEST (MOUNTAIN IRON)	101-20200	487.37
02/13	02/06/2013	143422	30072	COMPUTER WORLD	101-20200	202.96
02/13	02/06/2013	143423	60050	EARL F ANDERSEN	101-20200	289.90
02/13	02/06/2013	143424	500012	ERA LABORATORIES INC	602-20200	254.10
02/13	02/06/2013	143425	60026	FASTENAL COMPANY	101-20200	18.69
02/13	02/06/2013	143426	60002	FENA ADVERTISING INC	602-20200	91.50
02/13	02/06/2013	143427	70035	G & K SERVICES	101-20200	59.56
02/13	02/06/2013	143428	217	GE POWER & WATER	601-20200	14,907.43
02/13	02/06/2013	143429	70016	GOPHER STATE ONE CALL INC	604-20200	17.50
02/13	02/06/2013	143430	70007	GOVERNMENT TRAINING SERVICE	101-20200	210.00
02/13	02/06/2013	143431	70004	GRANDE ACE HARDWARE	101-20200	105.77
02/13	02/06/2013	143432	70028	GREATER MINNESOTA AGENCY INC	101-20200	204.00
02/13	02/06/2013	143433	70029	GUARDIAN PEST CONTROL INC	101-20200	81.81
02/13	02/06/2013	143434	80022	HAWKINS INC	601-20200	511.29
02/13	02/06/2013	143435	80045	HEALTHLINE MEDICAL SUPPLY	101-20200	210.00
02/13	02/06/2013	143436	80017	HENRY'S WATERWORKS INC	601-20200	406.18
02/13	02/06/2013	143437	80037	HOMETOWN MEDIA PARTNERS	101-20200	460.50
02/13	02/06/2013	143438	110006	KEN WASCHKE AUTO PLAZA	604-20200	107.74
02/13	02/06/2013	143439	110022	KOHLER FUEL COMPANY	602-20200	725.21
02/13	02/06/2013	143440	120032	LAKE COUNTRY POWER	101-20200	215.89
02/13	02/06/2013	143441	120002	LAWSON PRODUCTS INC	101-20200	665.59
02/13	02/06/2013	143442	120023	LOCATORS & SUPPLIES INC	601-20200	1,777.67
02/13	02/06/2013	143443	130060	MCCARTHY WELL COMPANY	601-20200	740.00
02/13	02/06/2013	143444	140026	MINNESOTA ENERGY RESOURCES	101-20200	4,886.08
02/13	02/06/2013	143445	130009	MINNESOTA POWER (ALLETE INC)	101-20200	1,435.99
02/13	02/06/2013	143446	130123	MORTON SALT	101-20200	2,019.70
02/13	02/06/2013	143447	130015	MOUNTAIN IRON PUBLIC UTILITIES	101-20200	17,683.87
02/13	02/06/2013	143448	140047	NARDINI FIRE EQUIPMENT CO INC	101-20200	792.48
02/13	02/06/2013	143449	140052	NORTHEAST SERVICE COOPERATIVE	101-20200	47,047.84
02/13	02/06/2013	143450	140055	NORTHERN VISUAL SERVICES LLP	101-20200	195.00
02/13	02/06/2013	143451	40032	OFFICE OF ENTERPRISE TECHNOLOG	101-20200	418.94
02/13	02/06/2013	143452	160066	PACE ANALYTICAL SERVICES	601-20200	560.30
02/13	02/06/2013	143453	160023	POHAKI LUMBER	101-20200	10.13
02/13	02/06/2013	143454	180071	RANGE REPAIR SERVICE (DBA)	602-20200	168.00
02/13	02/06/2013	143455	190072	SAINTE LOUIS COUNTY AUDITOR	102-20200	573.05
02/13	02/06/2013	143456	6072	SALLY PETERANGELO	101-20200	160.29
02/13	02/06/2013	143457	4044	SUMMER WORK OUTREACH PROGRAI	230-20200	500.00
02/13	02/06/2013	143458	210002	UNITED TRUCK BODY COMPANY INC	101-20200	47.90
02/13	02/06/2013	143459	210009	USA BLUE BOOK	602-20200	176.54
02/13	02/06/2013	143460	220025	VERIZON WIRELESS	101-20200	17.70
02/13	02/06/2013	143461	220014	VIKING INDUSTRIAL NORTH	604-20200	239.86
02/13	02/06/2013	143462	20026	VIRGINIA REG MEDICAL CENTER	230-20200	500.00
02/13	02/06/2013	143463	230028	WISCONSIN ENERGY CONSERVATION	604-20200	366.65
02/13	02/06/2013	143464	260005	ZEP MANUFACTURING COMPANY	101-20200	197.54
02/13	02/06/2013	143465	260001	ZIEGLER INC	603-20200	7.18
Totals:						106,266.70
Payroll-PP Ending 2/1/13						71,151.77
Wire Trans.-Fire Truck						76,000.00
-Transportation						3,240.00
TOTAL EXPENDITURES						\$256,658.47

St. Louis County Environmental Services Department

AMENDMENT TO SERVICE AGREEMENT FOR COLLECTION OF RESIDENTIAL AND COMMERCIAL RECYCLABLE MATERIALS

THIS AGREEMENT, made as of this 1st day of January, 2013, by and between ST. LOUIS COUNTY, a body corporate and politic existing under the laws of the State of Minnesota, hereinafter referred to as "County", and the CITY OF MT. IRON, residing at 8586 Enterprise Drive South; Mt. Iron, MN 55768 hereinafter referred to as "Provider."

WITNESSETH:

WHEREAS, the County and Provider entered into an Agreement, hereinafter referred to as the "Original Agreement" on January 1, 2008, which allows the County to pay for the processing and marketing of Curbside collected recyclable materials, up to a predetermined maximum tonnage, weighed and hauled by the Provider to the County-owned recyclables processing facility; and

WHEREAS, the parties desire to amend the Original Agreement so as to enable both parties to continue to enjoy the mutual benefits it provides by extending its term and services provided thereunder; and

WHEREAS, Section I. of the Original Agreement provides for two one-year extensions of the Original Agreement; and

WHEREAS, the County and Provider wish to enter into the first one-year extension of the Original Agreement.

NOW, THEREFORE, in consideration of the mutual covenants contained herein, and for other good and valuable considerations, the parties do agree as follows:

1. Extend the Term of the Original Agreement to December 31, 2013 upon the mutual agreement of both parties as allowed under Section I of the Original Agreement.
2. Amend Section VII. INSURANCE to read:

"The following insurance must be maintained for the duration of this contract. A Certificate of Insurance for each policy must be on file with St. Louis County Purchasing Department within 10 days of execution of this contract and prior to commencement of any work under this contract. Each certificate must include a 10-day notice of cancellation, non-renewal, or material change to all named and additional insureds.

The County reserves the right to rescind any contract not in compliance with these

requirements and retains all rights thereafter to pursue any legal remedies against the successful bidder. All insurance policies shall be open to inspection by the County, and copies of policies shall be submitted to the County upon written request. All subcontractors shall provide evidence of similar coverage.

General Liability Insurance

\$500,000 for claims for wrongful death and each claimant for other claims.

\$1,500,000 each occurrence.

No Less Than \$2,000,000 Aggregate coverage.

Policy shall include at least premises, operations, completed operations, independent contractors and subcontractors, and contractual liability and environmental liability.

St. Louis County must be named additional insured.

Business Automobile Liability Insurance

\$500,000 for claims for wrongful death and each claimant for other claims.

\$1,500,000 each occurrence.

Must cover owned, non-owned and hired vehicles.

Workers' Compensation

Per statutory requirements. Certificate of Compliance must be executed and filed with St. Louis County.

Indemnification Clause

Except as may be caused by the sole negligence of the County or its employees, Contractor shall indemnify and save harmless St. Louis County, its employees, and its agents from all claims, actions, demands, and judgments of any kind arising in whole or in part from any act or omission of Contractor, its subcontractors, and their agents, servants, or employees, incidental to the performance of the contract and from all expenses in connection with such claims, actions, demands and judgments, and shall assume, without expense to the County, the defense of any such claims, actions, demands and judgments, irrespective of whether it is alleged, claimed, or proved in connection with such act or omission that negligence of the County or its representatives caused or contributed thereto.

Contractor agrees, that in order to protect itself and the County under the indemnity provisions set forth above, it will at all times during the term of this Contract keep in force policies of insurances indicated in paragraph entitled "INSURANCE".

This provision is not intended to create any cause of action in favor of any third party against the Contractor of the County or to enlarge in any way the Contractor's liability, but it is intended solely to provide for indemnification of the County from liability for damages or injuries to third persons or property arising from the Contractor's or the Contractor's agents' performance hereunder.

- 3. All other provisions of the Original Agreement, except as amended herein, shall remain in full force and effect through its duration.

IN WITNESS THEREOF, the parties have executed the Original Agreement on the date and year first written above.

CITY OF MT. IRON

ST. LOUIS COUNTY

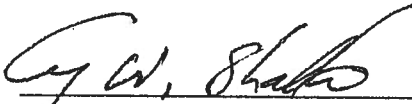
BY: 
GARY SKALKO
Mayor

BY: _____
CHRIS DAHLBERG, Chair
St. Louis County Board

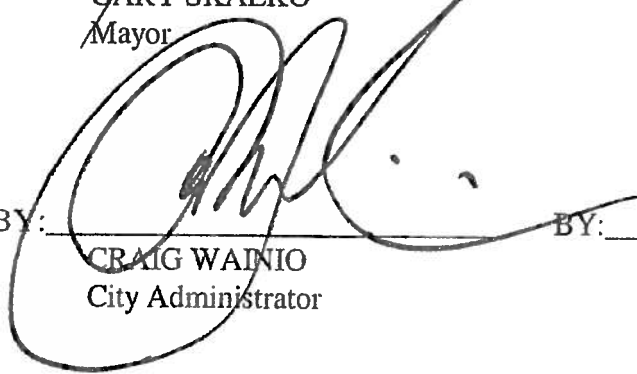
BY: 
CRAIG WAINIO
City Administrator

BY: _____
DONALD DICKLICH
County Auditor

BY: _____
TED TROOLIN, Director
Environmental Services Department

APPROVED AS TO FORM AND
EXECUTION:

BY: _____
JAMES NEPHEW
Assistant County Attorney



CITY OF MOUNTAIN IRON

"TACONITE CAPITAL OF THE WORLD"

PHONE: 218-748-7570 • FAX: 218-748-7573 • www.mtniron.com
8586 ENTERPRISE DRIVE SOUTH • MOUNTAIN IRON, MN • 55768-8260

RESOLUTION NUMBER 03-13

ORDERING PREPARATION OF REPORT ON IMPROVEMENT

WHEREAS, it is proposed to improve Unity Drive between the centerline of Diamond Lane and the centerline of Park Drive by construction and to assess the benefited property for all or a portion of the cost of the improvement, pursuant to Minnesota Statutes, Chapter 429.

NOW THEREFORE, BE IT RESOLVED BY THE CITY COUNCIL OF MOUNTAIN IRON, MINNESOTA:

That the proposed improvement be referred to Benchmark Engineering for study and that that person is instructed to report to the City Council with all convenient speed advising the City Council in a preliminary way as to whether the proposed improvement is necessary, cost-effective, and feasible; whether it should best be made as proposed or in connection with some other improvement; the estimated cost of the improvement as recommended; and a description of the methodology used to calculate individual assessments for affected parcels.

DULY ADOPTED BY THE CITY COUNCIL THIS 4th DAY OF FEBRUARY, 2013.

ATTEST:

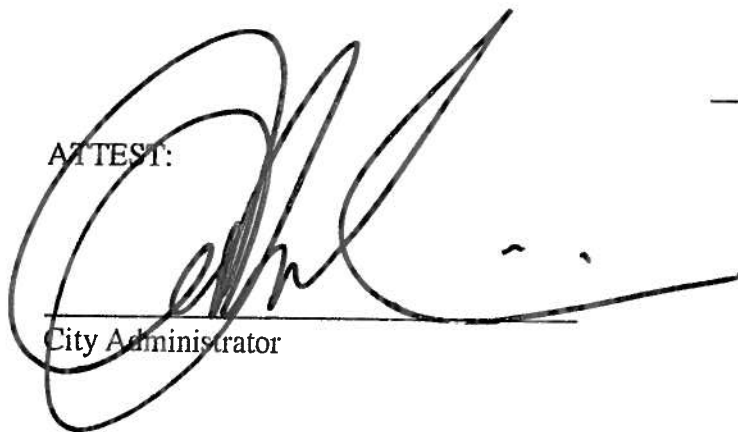

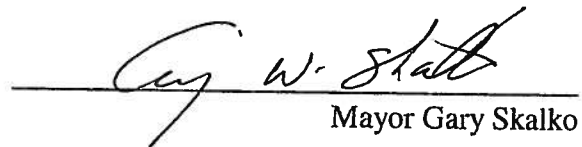
City Administrator

Mayor Gary Skalko



CITY OF MOUNTAIN IRON

"TACONITE CAPITAL OF THE WORLD"

PHONE: 218-748-7570 • FAX: 218-748-7573 • www.mtniron.com
8586 ENTERPRISE DRIVE SOUTH • MOUNTAIN IRON, MN • 55768-8260

RESOLUTION NUMBER 04-13

AUTHORIZING THE SUBMITTAL OF A SAFE ROUTES TO SCHOOL INFRASTRUCTURE APPLICATION TO THE MINNESOTA DEPARTMENT OF TRANSPORTATION

WHEREAS; the Minnesota Department of Transportation annually solicits applications for Safe Routes to School funding; and

WHEREAS; the City of Mountain Iron collaborated with the Mountain Iron-Buhl School District to complete the 2010 Mountain Iron Bicycle and Pedestrian Plan which included a local non-motorized trails plan and Safe Routes to School plan; and

WHEREAS, the City of Mountain Iron is committed to a community-effort to improve walking and bicycling conditions; and

NOW THEREFORE, BE IT RESOLVED BY THE CITY COUNCIL OF MOUNTAIN IRON, MINNESOTA, that the City of Mountain Iron approves the submittal of a Safe Routes to School Infrastructure Grant for Fiscal Year 2014 to help implement the Mountain Iron Bicycle and Pedestrian Plan;

DULY ADOPTED BY THE CITY COUNCIL THIS 4th DAY OF FEBRUARY, 2013.

ATTEST:

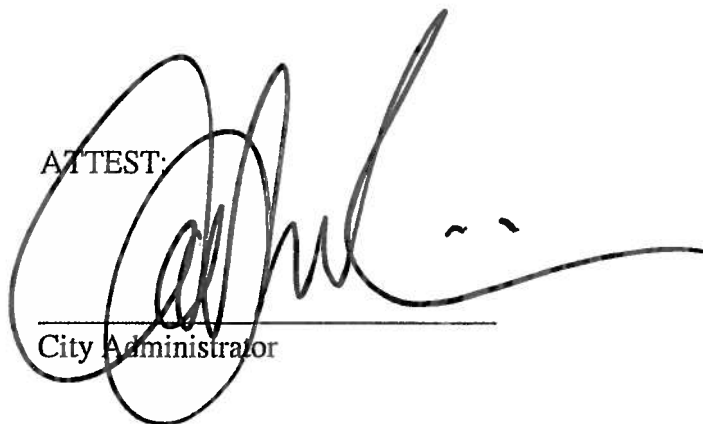

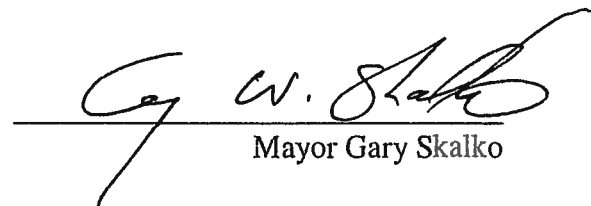
City Administrator

Mayor Gary Skalko

COUNCIL LETTER 021913-IVG

PLANNING AND ZONING

PRELIMINARY PLAT

DATE: February 14, 2013

FROM: Planning and Zoning Commission

Craig J. Wainio
City Administrator

At their meeting on February 11 the Planning and Zoning Commission approved the preliminary plat for the energy park and forwarded it to the City Council for their approval. If approved by the City Council, a final plat will be presented for approval of both boards. It is recommended that the City Council adopt the preliminary plat as presented.

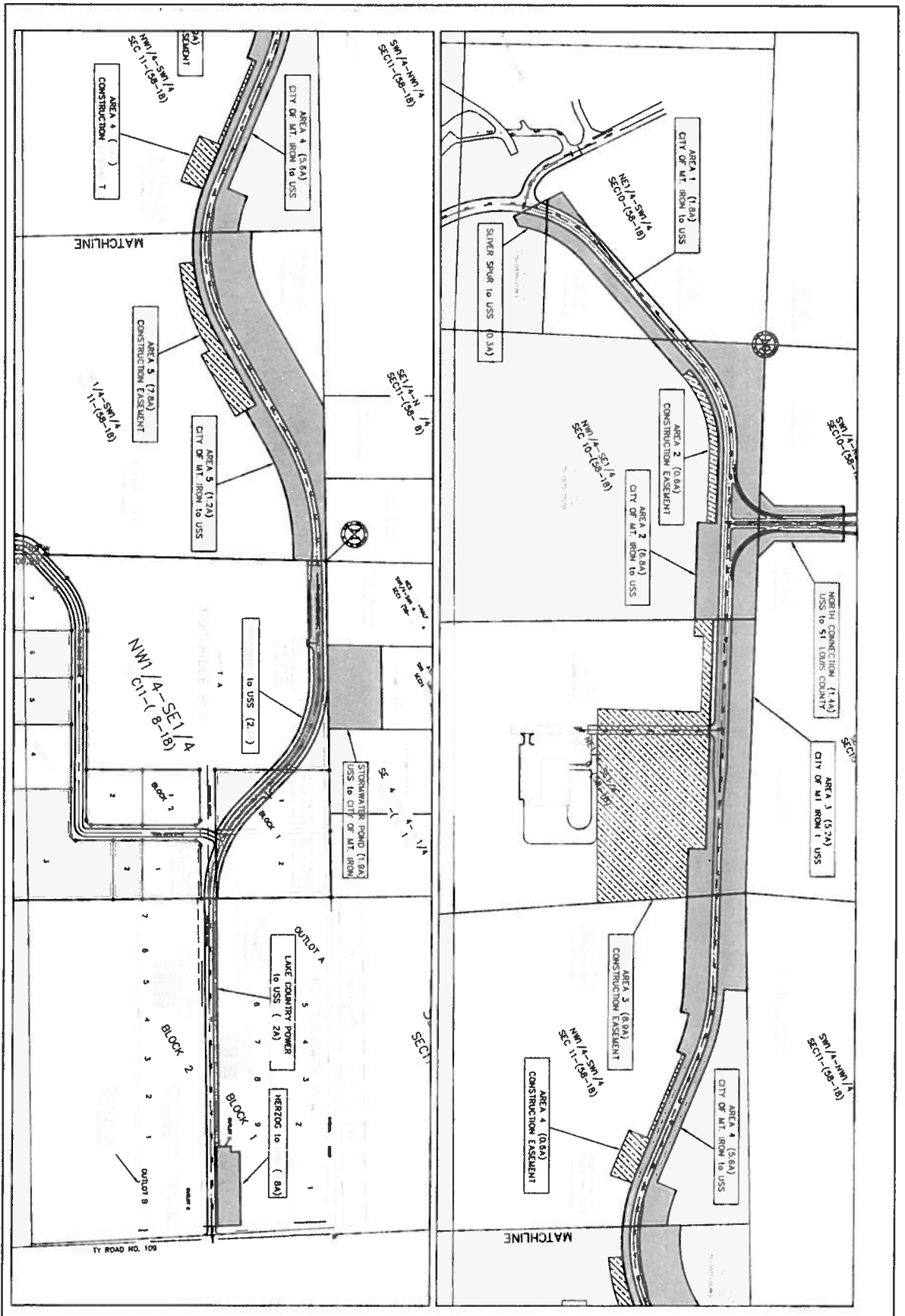

PROJECT NO. 11-08-18
 SHEET NO. 1
 DATE: 11/15/18

OWNER: CITY OF MT. IRON
 DESIGNER: BENCHMARK ENGINEERING, INC.
 CONTRACT NO. 11-08-18

COUNTY ROAD 102
 USS ENTRANCE ROAD
 MT. IRON, MINNESOTA
 ADJACENT PROPERTY OWNERS
 1 1

ENERGY PARK OF MOUNTAIN IRON

LOCATED IN THE NE1/4 OF THE SW1/4, NW1/4 OF THE SE1/4,
NE1/4 OF THE SE1/4 & SE1/4 OF THE SE1/4
SECTION 10, TOWNSHIP 58 NORTH, RANGE 18 WEST

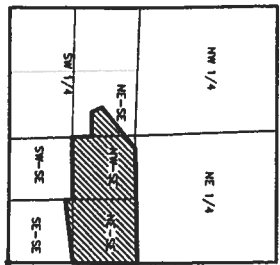
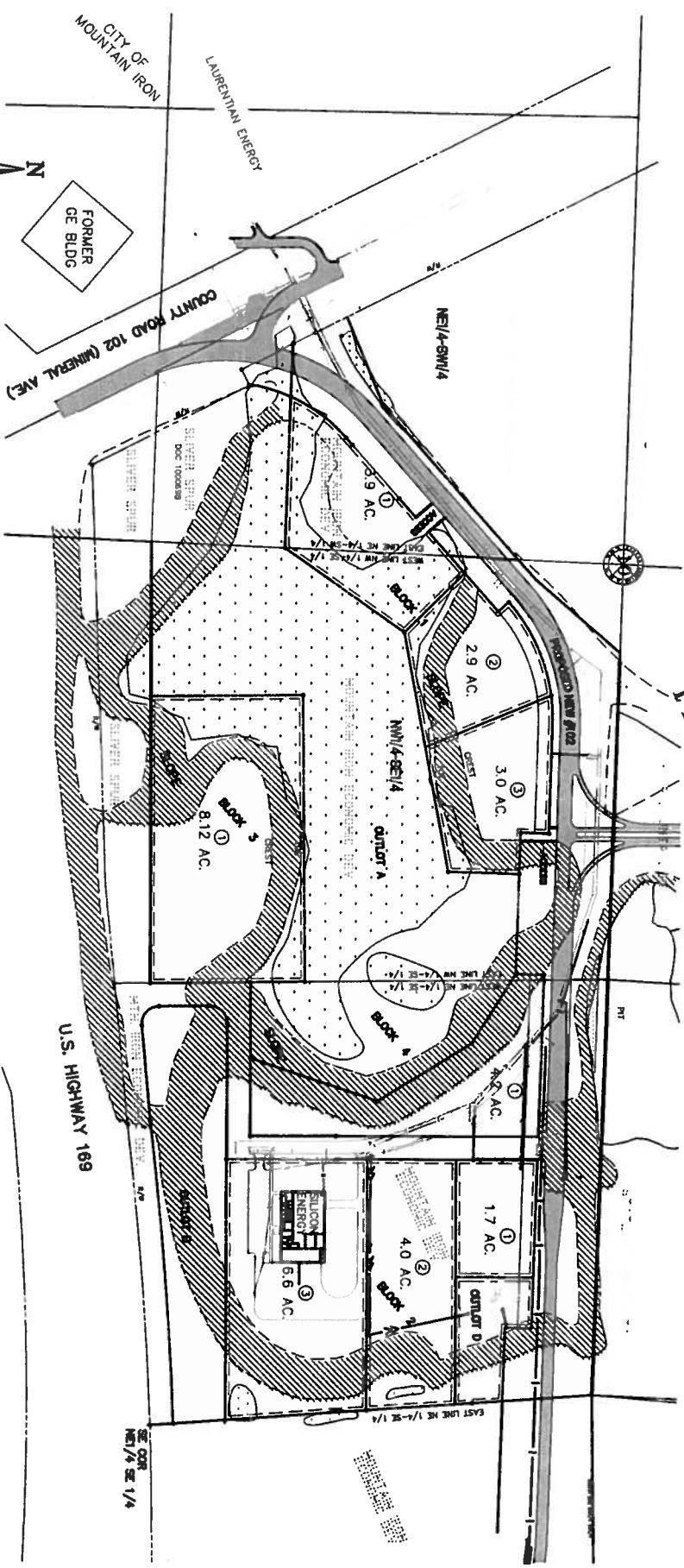

- LEGEND**
- DITCHES WORKMENT TOWNSHIP
 - CROWNED SLOPE AREA
 - PROPOSED POWER
 - EXISTING POWER
 - PROPOSED SANITARY
 - EXISTING SANITARY
 - PROPOSED WATER LINE
 - EXISTING WATER LINE
 - PROPOSED SEWER
 - EXISTING SEWER
 - PROPOSED GAS
 - EXISTING GAS
 - /// SLOPE AREA
 - WETLANDS

BENCHMARK ENGINEERING, INC.
 1000 1/2 Main Street, Suite 200
 Mountain Iron, CO 81449
 Phone: 970-732-8811
 Fax: 970-732-8812
 Email: info@benchmarkeng.com

BASIS OF BEARING:
 THE EAST LINE OF THE NORTHEAST QUARTER OF THE
 SOUTHWEST QUARTER IS ASSUMED A BEARING OF
 NORTH 03 DEGREES 59 MINUTES 40 SECONDS WEST.

NO SCALE

COUNCIL LETTER 021913-IVG

PERSONNEL COMMITTEE

FIREFIGHTER PAY

DATE: February 14, 2013
FROM: Personnel Committee
Craig J. Wainio
City Administrator

The Personnel Committee recommends to the City Council that the hourly rate for training and calls for the Mountain Iron Fire Department be increased from \$10 to \$12.

COUNCIL LETTER 021913-VIA

ADMINISTRATION

RESOLUTION 05-13

DATE: February 14, 2013

FROM: Craig J. Wainio
City Administrator

Resolution Number 05-13 Accepting the Feasibility Report for the extension of Unity Drive and sets a public hearing on the project for the second meeting in March. The feasibility report is attached for your review. The City Council should determine which would be their primary option of the scenarios addressed in the report. It is recommend that the City Council adopt Resolution Number 05-13 as presented.



CITY OF MOUNTAIN IRON

"TACONITE CAPITAL OF THE WORLD"

PHONE: 218-748-7570 • FAX: 218-748-7573 • www.mtniron.com
8586 ENTERPRISE DRIVE SOUTH • MOUNTAIN IRON, MN • 55768-8260

RESOLUTION NUMBER 05-13

RECEIVING REPORT AND CALLING HEARING ON IMPROVEMENT

WHEREAS, pursuant to Resolution Number 03-13 of the City Council adopted February 4, 2013, a report has been prepared by Benchmark Engineering with reference to improve Unity Drive between the centerline of Diamond Lane and the centerline of Park Drive by construction and this report was received by the City Council on February 19, 2012, and

WHEREAS, the report provides information regarding whether the proposed project is necessary, cost effective, and feasible; whether it should best be made as proposed or in connection with some other improvement; and the estimated cost of the improvement as recommended.

NOW THEREFORE, BE IT RESOLVED BY THE CITY COUNCIL OF MOUNTAIN IRON, MINNESOTA:

1. The City Council will consider the improvement of such streets in accordance with the report and the assessment of abutting property for all or a portion of the cost of the improvement pursuant to Minnesota Statutes, Chapter 429 at an estimated total cost of the improvement of \$750,000.
2. A public hearing shall be held on such proposed improvement on the 18th day of March, 2013, in the Mountain Iron Room of the Community Center at 5:00 p.m. and the City Administrator shall give mailed and published notice of such hearing and improvement as required by law.

DULY ADOPTED BY THE CITY COUNCIL THIS 19th DAY OF FEBRUARY, 2013.

ATTEST:

Mayor Gary Skalko

City Administrator

**Unity Drive Improvements
Feasibility Report
Project No. MI13-03**

**Mountain Iron, Minnesota
February 13, 2013**

Prepared by:



I hereby certify that this feasibility study was prepared by me, or under my supervision, and that I am a duly licensed Professional Engineer under the laws of the State of Minnesota.

Alan J. Johnson

Alan J. Johnson, P.E.

Date: February 13, 2013 License No. 48185

TABLE OF CONTENTS:

COVER PAGE

TABLE OF CONTENTS

BACKGROUND

EXISTING CONDITIONS

PROPOSED IMPROVEMENT PLAN

OPINION OF COST SUMMARY

SOURCES OF FUNDING

SUMMARY

ATTACHMENTS

- APPENDIX A: PROJECT LOCATION MAP
- APPENDIX B: DETAILED COST ESTIMATES

BACKGROUND

On February 4, 2013 the Mountain Iron City Council requested a feasibility report to make improvements to the Unity Drive from the centerline of Park Drive in the South Grove Addition to Diamond Lane in the Unity Second Addition of Mountain Iron. The City Council requested Benchmark Engineering evaluate whether the proposed improvement is necessary, cost effective and feasible.

EXISTING CONDITIONS

The existing Unity Drive corridor begins in the South Grove addition of Mountain Iron and heads east to Mountain Iron Drive, located near the easterly city limit boundary. The segment of Unity Drive for the focus of this study is from the South Grove Addition to Unity 2nd Addition of the City of Mountain Iron. Please refer to the Project Location Map as an attachment to this feasibility study.

The westerly portion of this segment is a gravel road that has been constructed in various phases over the last several years as adjacent land was developed for residential housing. The last improvement took place in 2008, which extended the road approximately 250 feet east to provide access to a residence. The easterly portion of the segment is unimproved up to the Diamond Lane intersection. On the east end, Unity Drive was constructed to a dead end in 2007 during the construction of streets and utilities in Unity Second Addition. The total length of the roadway segment in this study is approximately 3,300 feet. A total of 1,900 feet is currently a gravel surface and the remaining is unimproved, which renders the land adjacent to the corridor inaccessible.

In the 1998 water and sanitary sewer were extended through this corridor. The watermain is a ten inch ductile iron watermain and the sanitary sewer is an eight inch PVC pipe. Due to age and material type, it is generally assumed that these utilities are in good condition.

In 2008 a hydrology study was completed by Benchmark Engineering, Inc. The study recommended that 24" culverts be installed at two locations to maintain the historical drainage patterns if a roadway was constructed through this corridor. A copy of this study is available upon request.

PROPOSED IMPROVEMENT PLAN

The City Council and City Staff directed Benchmark Engineering to report on the feasibility of improvements to the Unity Drive Corridor from the South Grove Addition to the Unity Second Addition.

Based upon information available, proposed improvement alternatives were developed for the area described above. Please refer to the Project Location Map for an overview of the project area. The proposed improvements options are as follows.

Option 1 – Construct a Bituminous Street with Curb & Gutter, a Trail on one side, sidewalk on the other side.

A bituminous street would be designed and constructed to match the current Unity Drive corridor. A storm sewer system would be design and installed to provide drainage of the roadway and wetland crossings. A bituminous trail could be constructed on either side of the roadway, which would allow for pedestrian traffic and bicycles to safely move between the South Grove Addition and the Unity Second Addition area.

The trail would be constructed at 10 feet wide and a grass boulevard would be located between the street and the trail to allow for a separation distance between traffic and bike/pedestrians.

Utility services would be extended to the right-of-way limits at selected locations in order to prevent road cuts in the near future.

Advantages of this proposed improvement option:

- Matches the current typical section of Unity Drive adjacent to Unity Second Addition.
- Provide roadway access to adjacent landowners.
- Provides a safe route for pedestrians and bike users on both sides of the roadway segment.
- Provides South Grove Addition with a link to the trails/sidewalks within the City of Mountain Iron.
- Creates a lower speed access route for residents to travel between South Grove Addition and other areas within the City of Mountain Iron.

Disadvantages of this proposed improvement option:

- This option is the most expensive option.
- Maximum wetland impacts and additional wetland credits would need to be purchased in excess of those already purchased for bike/pedestrian access.

Option 2: Construct a bituminous Street with curb and gutters and a trail on one side. No Sidewalks

A bituminous street would be designed and constructed to match the current Unity Drive corridor. A storm sewer system would be design and installed drainage of the roadway and wetland crossings.

A bituminous trail could be constructed on either side of the roadway, which would allow for pedestrian traffic and bicycles to safely move from the South Grove Addition to the Unity Second Addition area.

The trail would be constructed at 10 feet wide and either attached to the back of the curb or a grass boulevard would be located between the curb and the trail to allow for a separation distance between traffic and bike/pedestrians.

Utility services would be extended to the right-of-way limits at selected locations in order to prevent road cuts in the near future.

Advantages of this proposed improvement option:

- Matches the current typical section of Unity Drive adjacent to Unity Second Addition.
- Provide roadway access to adjacent landowners.
- Provides a safe route for pedestrians and bike users on one side of the roadway segment.
- Provides South Grove Addition with a link to the trails/sidewalks within the City of Mountain Iron.
- Creates a lower speed access route for residents to travel between South Grove Addition and other areas within the City of Mountain Iron.
- Slightly reduces wetland impacts from Option 1.

Disadvantages of this proposed improvement option:

- This option is the second most expensive option.
- Additional wetland credits would need to be purchased in excess of those already purchased for bike/pedestrian access.
- Bike/pedestrian access on one side of the roadway

Option 3: Construct a bituminous Street with gravel shoulders and a trail on one side.

A bituminous street would be designed and constructed to match the current Unity Drive corridor, except no curb and gutter would be constructed. A storm sewer system would be design and installed to provide drainage at only the wetland crossings. Roadside ditches would be constructed to maintain the natural drainage patterns and to convey stormwater away from residential lots and land adjacent to the road.

Again, a 10 foot wide bituminous trail could be constructed on either side of the roadway, which would allow for pedestrian traffic and bicycles to safely move from the South Grove Addition to the Unity Second Addition area.

Utility services would be extended to the right-of-way limits at selected locations in order to prevent road cuts in the near future.

Advantages of this proposed improvement option:

- Matches the current typical rural section of Unity Drive from Mud Lake Road to County Road 7.
- Provide roadway access to adjacent landowners.
- Provides a safe route for pedestrians and bike users on one side of the roadway segment.
- Provides South Grove Addition with a link to the trails/sidewalks within the City of Mountain Iron.
- Creates a lower speed access route for residents to travel between South Grove Addition and other areas within the City of Mountain Iron.
- Slightly reduces wetland impacts from Options 1 & 2.
- Lower costs than Options 1 & 2 removal of curb & gutter.

Disadvantages of this proposed improvement option:

- Additional wetland credits would need to be purchased in excess of those already purchased for bike/pedestrian access.
- Bike/pedestrian access on one side of the roadway.
- Increased maintenance required on roadside ditching and gravel shoulders.

Option 4: Construct a gravel road with a bituminous bike trail. Roadway would be constructed ready for a bituminous overlay in the future.

The roadway would be reconstructed from South Grove Addition to Unity Second Addition of Mountain Iron. The road section would be designed with appropriate gravel and granular base material, so that when completed with bituminous, it would ultimately function as a 9 ton design roadway.

Again, a 10 foot wide bituminous trail could be constructed on either side of the roadway, which would allow for pedestrian traffic and bicycles to safely move from the South Grove Addition to the Unity Second Addition area. A grassed boulevard would likely be provided to create separation between the gravel roadway shoulder and trail.

Utility services would be extended to the right-of-way limits at selected locations in order to prevent road cuts in the near future.

Advantages of this proposed improvement option:

- Provide roadway access to adjacent landowners.
- Provides a safe route for pedestrians and bike users on one side of the roadway segment.
- Provides South Grove Addition with a link to the trails/sidewalks within the City of Mountain Iron.
- Creates a lower speed access route for residents to travel between South Grove Addition and other areas within the City of Mountain Iron.
- Lower cost than previously discussed options.

Disadvantages of this proposed improvement option:

- Additional wetland credits would need to be purchased in excess of those already purchased for bike/pedestrian access.
- Bike/pedestrian access on one side of the roadway.
- Increased maintenance required on roadside ditching and gravel shoulders.
- Frequent maintenance on gravel roadway surface with increased traffic.
- Dust control for residents along roadway corridor.
- Load rating of this portion of Unity Drive would be reduced until bituminous surface is placed.

Option 5: Construct a gravel road only where no roadway currently exists with a bituminous bike trail the entire length of segment. Road would be constructed ready for a bituminous overlay in the future.

The roadway would be reconstructed from South Grove Addition to Unity Second Addition of Mountain Iron only where no gravel road currently exists. The length of this road area that would need to be constructed is approximately 1,300 feet.

Gravel roadway would be constructed 24 feet wide with 8" of Class 5 aggregate and geotextile fabric. Ditches and culverts would be constructed to maintain the natural drainage patterns and to alleviate flooding in lots/land adjacent to the road. This road would be design to handle only local traffic and access to residents.

Again, a 10 foot wide bituminous trail could be constructed on either side of the roadway, which would allow for pedestrian traffic and bicycles to safely move from the South Grove Addition to the Unity Second Addition area. A grassed boulevard would likely be provided to create separation between the gravel roadway shoulder and trail.

Advantages of this proposed improvement option:

- Provide roadway access to adjacent landowners.
- Provides a safe route for pedestrians and bike users on one side of the roadway segment.
- Provides South Grove Addition with a link to the trails/sidewalks within the City of Mountain Iron.
- Creates a lower speed access route for residents to travel between South Grove Addition and other areas within the City of Mountain Iron.
- Lowest cost option.

Disadvantages of this proposed improvement option:

- Additional wetland credits would need to be purchased in excess of those already purchased for bike/pedestrian access.
- Bike/pedestrian access on one side of the roadway.
- Increased maintenance required on roadside ditching and gravel shoulders.
- Frequent maintenance on gravel roadway surface with increased traffic.
- Dust control for residents along roadway corridor.
- Roadway section would like not be sufficient to handle increased traffic.
- Creation of a 9-ton Collector route would require complete subgrade removal and roadway section upgrade in the future.
- Increased costs of annual maintenance.

OPINION OF COST SUMMARY

The following table summarizes the engineer's opinion of cost for each of the improvements included in this report. A complete cost estimate breakdown for this improvement plan is included within Appendix B of this report.

ITEM	ESTIMATED COST
OPTION 1 – CONSTRUCT PAVED ROAD WITH CURB & GUTTER, 10 FOOT TRAIL & CONCRETE SIDEWALK	\$982,879
OPTION 2 – CONSTRUCT PAVED ROAD WITH CURB & GUTTER, 10 FOOT WIDE TRAIL ON ONE SIDE AND NO SIDEWALK	\$913,703
OPTION 3 – CONSTRUCT PAVED ROAD (RURAL SECTION), 10 FOOT TRAIL ON ONE SIDE.	\$742,161
OPTION 4 – CONSTRUCT A GRAVEL ROAD READY FOR FUTURE PAVING AND A 10 FOOT WIDE BITUMINOUS TRAIL	\$512,541
OPTION 5 – CONSTRUCT A GRAVEL ROAD ONLY WHERE NO GRAVEL ROAD EXISTS AND A 10 FOOT WIDE BITUMINOUS TRAIL	\$228,085

SOURCES OF FUNDING

In 2011 the City of Mountain Iron purchased wetland credits to extend a bike/pedestrian access through this area. The City of Mountain Iron has received a grant in the amount of \$100,000 through the Minnesota Safe Routes to School (SRTS) Infrastructure Program to assist with design and construction costs of the bike/pedestrian access.

In 2012 the City of Mountain Iron received a grant from Iron Range Resources and Rehabilitation Board (IRRRB) for \$250,000 to make roadway improvements through this area. City Staff has indicated if additional funds are needed to complete this project, they would likely come out of the City's General Fund.

The City of Mountain Iron intends to assess property owners adjacent to this project area for a portion of the improvement costs. The City of Mountain Iron would be responsible for the remaining portion of the balance to complete any of these improvement options.

SUMMARY

In conclusion, the afore-mentioned information attempts to summarize the existing conditions and proposed improvement options for the Unity Drive corridor within the City of Mountain Iron.

Currently the area between South Grove Addition and Unity Second Addition to Mountain Iron are not directly connected with a road or an improved trail. In the late 1990's, water and sanitary sewer was completed through the area. Over the last 15 years, several residential homes were built through this corridor and a minimal section gravel road was extended as access to residential properties was required.

It is our opinion, based on this preceding information and summary of improvement options, that Options 2 or 3 would be the most feasible and would provide the City of Mountain Iron with the best long term improvement options. This improvement would create a shorter route from South Grove to the Unity Second Addition area, a safe route for bikes and pedestrian traffic, and access for residential home owners adjacent to this improvement area.

Grant funding as outlined in the study has been committed to the project and the City of Mountain Iron could utilize these funds for any improvements. This will aid in the financing of this project, and lower the costs that would ultimately be the responsibility of the City of Mountain Iron and adjacent property owners.

Should the City of Mountain Iron intend to move forward with the above discussed improvements, it is recommended that the City Council or Street & Alley Committee decide whether to proceed with Option 2 (curb & gutter, urban design section) or Option 3 (roadside ditches, rural design section).

APPENDIX A: PROJECT LOCATION MAP



PROJECT LOCATION MAP



BENCHMARK
ENGINEERING, INC.

9375 Main Street
P.O. Box 261
Moorhead, MN 56508
Phone: 218-725-8914
Fax: 218-725-8923
E-Mail: info@ben-eng.com
Website: www.ben-eng.com

- CIVIL ENGINEERING
- ENVIRONMENTAL ENGINEERING
- LAND SURVEYING
- PLANNING
- TESTING
- LAND DATA BASE MAPPING

PROJECT NO. M13-03
DATE: FEB. 2013
DRAWN BY: JBA
CHECKED BY: AJ

DATE	REVISIONS	DESCRIPTION

**UNITY DRIVE
CONSTRUCTION**

MTN. IRON, MINNESOTA

**LOCATION MAP/
PROPERTY OWNERSHIPS**

SHEET NO.
1 OF 1

Small text at the bottom of the page, likely a copyright or disclaimer notice.

APPENDIX B: DETAILED COST ESTIMATES

**ENGINEER'S ESTIMATE OF QUANTITIES AND OPINION OF COST
IMPROVEMENTS TO UNITY DRIVE CORRIDOR
CITY OF MOUNTAIN IRON, MINNESOTA
PROJECT NO: MI13-03**

NOTE: OPTION 1 - BITUMINOUS STREET WITH CURB & GUTTER AND SIDEWALK ON ONE SIDE A BIKE/PEDESTRAIN TRAIL ON OTHER SIDE.

SPEC. NO.	ITEM	UNITS	EST. QUANTITIES TOTAL	UNIT COST	TOTAL AMOUNT
2105.501	COMMON EXCAVATION (PV)	CU. YD.	10,266.0	\$9.00	\$92,394.00
2105.533	SALVAGE AGGREGATE	CU. YD.	750.0	\$12.00	\$9,000.00
2105.503	ROCK EXCAVATION	CU. YD.	100.0	\$50.00	\$5,000.00
2104.604	GEOTEXTILE FABRIC TYPE V	SQ. YD.	18,200.0	\$1.50	\$27,300.00
2105.525	TOPSOIL BORROW	CU. YD.	250.0	\$20.00	\$5,000.00
2105.607	SELECT GRANULAR BORROW (CV)	CU. YD.	4,000.0	\$8.00	\$32,000.00
2211.503	AGGREGATE BASE (CV) CLASS V	CU. YD.	4,033.0	\$16.00	\$64,528.00
2350.501	TYPE LV 5 WEARING COURSE MIXTURE	TON	1,750.0	\$67.00	\$117,250.00
2350.502	TYPE LV 3 NON WEARING COURSE MIXTURE	TON	2,000.0	\$66.00	\$132,000.00
2501.515	15" RC PIPE APRON	EACH	4.0	\$400.00	\$1,600.00
2501.515	24" RC PIPE APRON	EACH	6.0	\$450.00	\$2,700.00
2502.541	4" PERFORATED PIPE DRAIN	LIN. FT.	6,600.0	\$4.00	\$26,400.00
2503.541	12" RCP DESIGN 3006 CL III	LIN. FT.	180.0	\$40.00	\$7,200.00
2503.541	15" RCP DESIGN 3006 CL III	LIN. FT.	150.0	\$43.00	\$6,450.00
2503.541	24" RCP DESIGN 3006 CL III	LIN. FT.	175.0	\$45.00	\$7,875.00
2503.602	8"X6" PVC WYE	EACH	15.0	\$150.00	\$2,250.00
2503.603	6" PVC PIPE SEWER	LIN. FT.	450.0	\$30.00	\$13,500.00
2504.602	ADJUST GATE VALVE AND BOX	EACH	5.0	\$150.00	\$750.00
2504.602	1" CORPORTATION STOP	EACH	15.0	\$175.00	\$2,625.00
2504.602	1.5" CURB STOP & BOX	EACH	15.0	\$175.00	\$2,625.00
2504.603	1" TYPE K COPPER	LIN. FT.	450.0	\$25.00	\$11,250.00
2506.501	CONSTRUCT DRAINAGE STRUCTURE DESIGN F	LIN. FT.	30.0	\$250.00	\$7,500.00
2506.501	CONSTRUCT DRAINAGE STRUCTURE DESIGN G	LIN. FT.	30.0	\$225.00	\$6,750.00
2506.501	CONSTRUCT DRAINAGE STRUCTURE DESING 48-4020	LIN. FT.	12.0	\$300.00	\$3,600.00
2506.516	CASTING ASSEMBLY	EACH	14.0	\$600.00	\$8,400.00
2506.522	ADJUST FRAME AND RING CASTING	EACH	8.0	\$350.00	\$2,800.00
2521.501	4" CONCRETE WALK	SQ. FT.	16,500.0	\$3.25	\$53,625.00
2531.501	CONCRETE CURB AND GUTTER DES. B618	LIN. FT.	6,600.0	\$13.00	\$85,800.00
2563.601	TRAFFIC CONTROL	LUMP SUM	1.0	\$4,500.00	\$4,500.00
2573.502	SILT FENCE PREASSEMBLED	LIN. FT.	3,300.0	\$3.50	\$11,550.00
2573.530	INLET PROTECTION	EACH	8.0	\$75.00	\$600.00
2573.602	DITCH CHECK	EACH	8.0	\$200.00	\$1,600.00
2573.602	TEMPORARY ROCK CONSTRUCTION ENTRANCE	EACH	2.0	\$1,500.00	\$3,000.00
2575.555	TURF ESTABLISHMENT	LUMP SUM	1.0	\$2,500.00	\$2,500.00

ESTIMATED COST OF CONSTRUCTION: \$761,922.00
CONTINGENCY (10%): \$76,192.20
ESTIMATED ENGINEERING DESIGN AND CONSTRUCTION COST: \$144,765.18
TOTAL PROJECT COST: \$982,879.38

1. ASSUMES STREET SECTION IS 32 FEET WIDE, 1.5" WEARING COURSE, 3.5" NONWEARING COURSE, 8" CLASS V, AND 12" SELECT GRANULAR.
2. SIDEWALK INCLUDED ON SOUTH SIDE OF STREET ONLY.
3. ASSUMES WATER AND SEWER SERVICES WOULD BE EXTENDED TO BOTH SIDES OF THE PROPOSED ROAD IN CONJUNCTION WITH THIS PROJECT.
4. ASSUMES CONSTRUCTING APPROXIMATELY 3300 FEET OF ROAD.
5. INCLUDES CONSTRUCTION OF STORM SEWER.

**ENGINEER'S ESTIMATE OF QUANTITIES AND OPINION OF COST
IMPROVEMENTS TO UNITY DRIVE CORRIDOR
CITY OF MOUNTAIN IRON, MINNESOTA
PROJECT NO: MI13-03**

NOTE: OPTION 2 - BITUMINOUS STREET WITH CURB & GUTTER AND A BIKE/PEDESTRAIN TRAIL ON OTHER SIDE. NO SIDEWALKS

SPEC. NO.	ITEM	UNITS	EST. QUANTITIES TOTAL	UNIT COST	TOTAL AMOUNT
2105.501	COMMON EXCAVATION (PV)	CU. YD.	10,266.0	\$9.00	\$92,394.00
2105.533	SALVAGE AGGREGATE	CU. YD.	750.0	\$12.00	\$9,000.00
2105.503	ROCK EXCAVATION	CU. YD.	100.0	\$50.00	\$5,000.00
2104.604	GEOTEXTILE FABRIC TYPE V	SQ. YD.	18,200.0	\$1.50	\$27,300.00
2105.525	TOPSOIL BORROW	CU. YD.	250.0	\$20.00	\$5,000.00
2105.607	SELECT GRANULAR BORROW (CV)	CU. YD.	4,000.0	\$8.00	\$32,000.00
2211.503	AGGREGATE BASE (CV) CLASS V	CU. YD.	4,033.0	\$16.00	\$64,528.00
2350.501	TYPE LV 5 WEARING COURSE MIXTURE	TON	1,750.0	\$67.00	\$117,250.00
2350.502	TYPE LV 3 NON WEARING COURSE MIXTURE	TON	2,000.0	\$66.00	\$132,000.00
2501.515	15" RC PIPE APRON	EACH	4.0	\$400.00	\$1,600.00
2501.515	24" RC PIPE APRON	EACH	6.0	\$450.00	\$2,700.00
2502.541	4" PERFORATED PIPE DRAIN	LIN. FT.	6,600.0	\$4.00	\$26,400.00
2503.541	12" RCP DESIGN 3006 CL III	LIN. FT.	180.0	\$40.00	\$7,200.00
2503.541	15" RCP DESIGN 3006 CL III	LIN. FT.	150.0	\$43.00	\$6,450.00
2503.541	24" RCP DESIGN 3006 CL III	LIN. FT.	175.0	\$45.00	\$7,875.00
2503.602	8"X6" PVC WYE	EACH	15.0	\$150.00	\$2,250.00
2503.603	6" PVC PIPE SEWER	LIN. FT.	450.0	\$30.00	\$13,500.00
2504.602	ADJUST GATE VALVE AND BOX	EACH	5.0	\$150.00	\$750.00
2504.602	1" CORPORTATION STOP	EACH	15.0	\$175.00	\$2,625.00
2504.602	1.5" CURB STOP & BOX	EACH	15.0	\$175.00	\$2,625.00
2504.603	1" TYPE K COPPER	LIN. FT.	450.0	\$25.00	\$11,250.00
2506.501	CONSTRUCT DRAINAGE STRUCTURE DESIGN F	LIN. FT.	30.0	\$250.00	\$7,500.00
2506.501	CONSTRUCT DRAINAGE STRUCTURE DESIGN G	LIN. FT.	30.0	\$225.00	\$6,750.00
2506.501	CONSTRUCT DRAINAGE STRUCTURE DESING 48-4020	LIN. FT.	12.0	\$300.00	\$3,600.00
2506.516	CASTING ASSEMBLY	EACH	14.0	\$600.00	\$8,400.00
2506.522	ADJUST FRAME AND RING CASTING	EACH	8.0	\$350.00	\$2,800.00
2531.501	CONCRETE CURB AND GUTTER DES. B618	LIN. FT.	6,600.0	\$13.00	\$85,800.00
2563.601	TRAFFIC CONTROL	LUMP SUM	1.0	\$4,500.00	\$4,500.00
2573.502	SILT FENCE PREASSEMBLED	LIN. FT.	3,300.0	\$3.50	\$11,550.00
2573.530	INLET PROTECTION	EACH	8.0	\$75.00	\$600.00
2573.602	DITCH CHECK	EACH	8.0	\$200.00	\$1,600.00
2573.602	TEMPORARY ROCK CONSTRUCTION ENTRANCE	EACH	2.0	\$1,500.00	\$3,000.00
2575.555	TURF ESTABLISHMENT	LUMP SUM	1.0	\$2,500.00	\$2,500.00

ESTIMATED COST OF CONSTRUCTION: \$708,297.00
 CONTINGENCY (10%): \$70,829.70
 ESTIMATED ENGINEERING DESIGN AND CONSTRUCTION COST: \$134,576.43
TOTAL PROJECT COST: \$913,703.13

1. ASSUMES STREET SECTION IS 32 FEET WIDE, 1.5" WEARING COURSE, 3.5" NONWEARING COURSE, 8" CLASS V, AND 12" SELECT GRANULAR.
2. SIDEWALK INCLUDED ON SOUTH SIDE OF STREET ONLY.
3. ASSUMES WATER AND SEWER SERVICES WOULD BE EXTENDED TO BOTH SIDES OF THE PROPOSED ROAD IN CONJUNCTION WITH THIS PROJECT.
4. ASSUMES CONSTRUCTING APPROXIMATELY 3300 FEET OF ROAD.
5. INCLUDES CONSTRUCTION OF STORM SEWER.

**ENGINEER'S ESTIMATE OF QUANTITIES AND OPINION OF COST
IMPROVEMENTS TO UNITY DRIVE CORRIDOR
CITY OF MOUNTAIN IRON, MINNESOTA
PROJECT NO: MI13-03**

NOTE: OPTION 3 - BITUMINOUS STREET WITH GRAVEL SHOULDERS AND 10 FOOT BIKE TRAIL TO ONE SIDE

SPEC. NO.	ITEM	UNITS	EST. QUANTITIES TOTAL	UNIT COST	TOTAL AMOUNT
2105.501	COMMON EXCAVATION (PV)	CU. YD.	10,266.0	\$9.00	\$92,394.00
2105.533	SALVAGE AGGREGATE	CU. YD.	750.0	\$12.00	\$9,000.00
2105.503	ROCK EXCAVATION	CU. YD.	100.0	\$50.00	\$5,000.00
2104.604	GEOTEXTILE FABRIC TYPE V	SQ. YD.	18,200.0	\$1.50	\$27,300.00
2105.525	TOPSOIL BORROW	CU. YD.	250.0	\$20.00	\$5,000.00
2105.603	CONSTRUCT DRAINAGE DITCH	LIN. FT.	2,500.0	\$8.00	\$20,000.00
2105.607	SELECT GRANULAR BORROW (CV)	CU. YD.	4,000.0	\$8.00	\$32,000.00
2211.503	AGGREGATE BASE (CV) CLASS V	CU. YD.	4,000.0	\$16.00	\$64,000.00
2350.501	TYPE LV 5 WEARING COURSE MIXTURE	TON	1,750.0	\$67.00	\$117,250.00
2350.502	TYPE LV 3 NON WEARING COURSE MIXTURE	TON	2,000.0	\$66.00	\$132,000.00
2501.515	24" RC PIPE APRON	EACH	6.0	\$450.00	\$2,700.00
2503.541	24" RCP DESIGN 3006 CL III	LIN. FT.	175.0	\$45.00	\$7,875.00
2503.602	8"X6" PVC WYE	EACH	15.0	\$150.00	\$2,250.00
2503.603	6" PVC PIPE SEWER	LIN. FT.	450.0	\$30.00	\$13,500.00
2504.602	ADJUST GATE VALVE AND BOX	EACH	5.0	\$150.00	\$750.00
2504.602	1" CORPORTATION STOP	EACH	15.0	\$175.00	\$2,625.00
2504.602	1.5" CURB STOP & BOX	EACH	15.0	\$175.00	\$2,625.00
2504.603	1" TYPE K COPPER	LIN. FT.	450.0	\$30.00	\$13,500.00
2506.522	ADJUST FRAME AND RING CASTING	EACH	8.0	\$300.00	\$2,400.00
2563.601	TRAFFIC CONTROL	LUMP SUM	1.0	\$4,500.00	\$4,500.00
2573.502	SILT FENCE - PREASSEMBLED	LIN. FT.	3,300.0	\$3.50	\$11,550.00
2573.602	DITCH CHECK	EACH	8.0	\$200.00	\$1,600.00
2573.602	TEMPORARY ROCK CONSTRUCTION ENTRANCE	EACH	2.0	\$1,500.00	\$3,000.00
2575.555	TURF ESTABLISHMENT	LUMP SUM	1.0	\$2,500.00	\$2,500.00

ESTIMATED COST OF CONSTRUCTION: \$575,319.00
CONTINGENCY (10%): \$57,531.90
ESTIMATED ENGINEERING DESIGN AND CONSTRUCTION COST: \$1,093,310.61
TOTAL PROJECT COST: \$742,161.51

1. ASSUMES STREET SECTION IS 32 FEET WIDE, 1.5" WEARING COURSE, 3.5" NONWEARING COURSE, 8" CLASS V, AND 12" SELECT GRANULAR.
2. ASSUMES WATER AND SEWER SERVICES WOULD BE EXTENDED TO BOTH SIDES OF THE PROPOSED ROAD IN CONJUNCTION WITH THIS PROJECT.
3. ASSUMES CONSTRUCTING APPROXIMATELY 3300 FEET OF ROAD.

**ENGINEER'S ESTIMATE OF QUANTITIES AND OPINION OF COST
IMPROVEMENTS TO UNITY DRIVE CORRIDOR
CITY OF MOUNTAIN IRON, MINNESOTA
PROJECT NO: MI13-03**

NOTE: OPTION 4 - CONSTRUCT A GRAVEL STREET AND BITUMINOUS TRAIL. STREET WOULD BE READY FOR FUTURE PAVING

SPEC. NO.	ITEM	UNITS	EST. QUANTITIES	UNIT COST	TOTAL AMOUNT
			TOTAL		
2105.501	COMMON EXCAVATION (PV)	CU. YD.	10,266.0	\$9.00	\$92,394.00
2105.533	SALVAGE AGGREGATE	CU. YD.	750.0	\$12.00	\$9,000.00
2105.503	ROCK EXCAVATION	CU. YD.	100.0	\$50.00	\$5,000.00
2104.604	GEOTEXTILE FABRIC TYPE V	SQ. YD.	18,200.0	\$1.50	\$27,300.00
2105.525	TOPSOIL BORROW	CU. YD.	250.0	\$20.00	\$5,000.00
2105.603	CONSTRUCT DRAINAGE DITCH	LIN. FT.	2,500.0	\$8.00	\$20,000.00
2105.607	SELECT GRANULAR BORROW (CV)	CU. YD.	4,000.0	\$8.00	\$32,000.00
2211.503	AGGREGATE BASE (CV) CLASS V	CU. YD.	4,000.0	\$16.00	\$64,000.00
2350.501	TYPE LV 5 WEARING COURSE MIXTURE	TON	750.0	\$95.00	\$71,250.00
2501.515	24" RC PIPE APRON	EACH	6.0	\$450.00	\$2,700.00
2503.541	24" RCP DESIGN 3006 CL III	LIN. FT.	175.0	\$45.00	\$7,875.00
2503.602	8"X6" PVC WYE	EACH	15.0	\$150.00	\$2,250.00
2503.603	6" PVC PIPE SEWER	LIN. FT.	450.0	\$30.00	\$13,500.00
2504.602	ADJUST GATE VALVE AND BOX	EACH	5.0	\$150.00	\$750.00
2504.602	1" CORPORTATION STOP	EACH	15.0	\$175.00	\$2,625.00
2504.602	1.5" CURB STOP & BOX	EACH	15.0	\$175.00	\$2,625.00
2504.603	1" TYPE K COPPER	LIN. FT.	450.0	\$30.00	\$13,500.00
2506.522	ADJUST FRAME AND RING CASTING	EACH	8.0	\$300.00	\$2,400.00
2563.601	TRAFFIC CONTROL	LUMP SUM	1.0	\$4,500.00	\$4,500.00
2573.502	SILT FENCE - PREASSEMBLED	LIN. FT.	3,300.0	\$3.50	\$11,550.00
2573.602	DITCH CHECK	EACH	8.0	\$200.00	\$1,600.00
2573.602	TEMPORARY ROCK CONSTRUCTION ENTRANCE	EACH	2.0	\$1,500.00	\$3,000.00
2575.555	TURF ESTABLISHMENT	LUMP SUM	1.0	\$2,500.00	\$2,500.00

ESTIMATED COST OF CONSTRUCTION: \$397,319.00
 CONTINGENCY (10%): \$39,731.90
ESTIMATED ENGINEERING DESIGN AND CONSTRUCTION COST: \$75,490.61
TOTAL PROJECT COST: \$512,541.51

1. ASSUMES STREET SECTION IS 32 FEET WIDE, 8" CLASS V, AND 12" SELECT GRANULAR AND GEOTEXTILE FABRIC.
2. ASSUMES WATER AND SEWER SERVICES WOULD BE EXTENDED TO BOTH SIDES OF THE PROPOSED ROAD IN CONJUNCTION WITH THIS PROJECT.
3. ASSUMES CONSTRUCTING APPROXIMATELY 3300 FEET OF ROAD.



**ENGINEER'S ESTIMATE OF QUANTITIES AND OPINION OF COST
IMPROVEMENTS TO UNITY DRIVE CORRIDOR
CITY OF MOUNTAIN IRON, MINNESOTA
PROJECT NO: MI13-03**

NOTE: OPTION 5 - CONSTRUCT MINIMAL GRAVEL ROAD AND BITUMINOUS BIKE TRAIL

SPEC. NO.	ITEM	UNITS	EST. QUANTITIES TOTAL	UNIT COST	TOTAL AMOUNT
2105.501	COMMON EXCAVATION (PV)	CU. YD.	1,900.0	\$8.00	\$15,200.00
2105.503	ROCK EXCAVATION	CU. YD.	25.0	\$50.00	\$1,250.00
2104.604	GEOTEXTILE FABRIC TYPE V	SQ. YD.	8,650.0	\$1.75	\$15,137.50
2105.525	TOPSOIL BORROW	CU. YD.	170.0	\$20.00	\$3,400.00
2105.603	CONSTRUCT DRAINAGE DITCH	LIN. FT.	1,300.0	\$8.00	\$10,400.00
2211.503	AGGREGATE BASE (CV) CLASS V	CU. YD.	1,900.0	\$16.00	\$30,400.00
2350.501	TYPE LV 5 WEARING COURSE MIXTURE	TON	750.0	\$95.00	\$71,250.00
2501.515	24" RC PIPE APRON	EACH	4.0	\$450.00	\$1,800.00
2503.541	24" RCP DESIGN 3006 CL III	LIN. FT.	120.0	\$45.00	\$5,400.00
2504.602	ADJUST GATE VALVE AND BOX	EACH	3.0	\$150.00	\$450.00
2506.522	ADJUST FRAME AND RING CASTING	EACH	4.0	\$250.00	\$1,000.00
2563.601	TRAFFIC CONTROL	LUMP SUM	1.0	\$4,500.00	\$4,500.00
2573.502	SILT FENCE - PREASSEMBLED	LIN. FT.	1,300.0	\$2.25	\$2,925.00
2573.602	DITCH CHECK	EACH	8.0	\$200.00	\$1,600.00
2573.602	TEMPORARY ROCK CONSTRUCTION ENTRANCE	EACH	2.0	\$1,500.00	\$3,000.00
2575.555	TURF ESTABLISHMENT	LUMP SUM	1.0	\$2,500.00	\$2,500.00

ESTIMATED COST OF CONSTRUCTION: \$170,212.50
CONTINGENCY (15%): \$25,531.88
ESTIMATED ENGINEERING DESIGN AND CONSTRUCTION COST: \$32,340.38
TOTAL PROJECT COST: \$228,084.75

1. ASSUMES STREET SECTION IS 24 FEET WIDE WITH 8" AGGREGATE BASE CLASS V AND GEOTEXTILE FABRIC.
2. ASSUMES CONSTRUCTING APPROXIMATELY 1,300 FEET OF ROAD.
3. ROADWAY WOULD NEED TO BE COMPLETELY RECONSTRUCTED PRIOR TO A BITUMINOUS PAVING.

COUNCIL LETTER 021913-VIB

ADMINISTRATION

RESOLUTION 06-13

DATE: February 14, 2013

FROM: Craig J. Wainio
City Administrator

Resolution Number 06-13 Ordering a Feasibility Study is ordering a study for the paving of Silicon Drive between the proposed new Highway 169 and the Silicon Energy facility. This project is intended to be funded through a grant for the Department of Employment and Economic Development. Once the feasibility report is completed, it will be presented to the City Council and a public hearing will be scheduled. It is recommended that the City Council adopt Resolution Number 06-13 as presented.



CITY OF MOUNTAIN IRON

"TACONITE CAPITAL OF THE WORLD"

PHONE: 218-748-7570 • FAX: 218-748-7573 • www.mtniron.com
8586 ENTERPRISE DRIVE SOUTH • MOUNTAIN IRON, MN • 55768-8260

RESOLUTION NUMBER 06-13

ORDERING PREPARATION OF REPORT ON IMPROVEMENT

WHEREAS, it is proposed to improve Silicon Drive between the centerline of the proposed County Road 102 to the end of Silicon Drive by paving and to assess the benefited property for all or a portion of the cost of the improvement, pursuant to Minnesota Statutes, Chapter 429.

NOW THEREFORE, BE IT RESOLVED BY THE CITY COUNCIL OF MOUNTAIN IRON, MINNESOTA:

That the proposed improvement be referred to Benchmark Engineering for study and that that person is instructed to report to the City Council with all convenient speed advising the City Council in a preliminary way as to whether the proposed improvement is necessary, cost-effective, and feasible; whether it should best be made as proposed or in connection with some other improvement; the estimated cost of the improvement as recommended; and a description of the methodology used to calculate individual assessments for affected parcels.

DULY ADOPTED BY THE CITY COUNCIL THIS 19th DAY OF FEBRUARY, 2013.

ATTEST:

Mayor Gary Skalko

City Administrator

COUNCIL LETTER 021913-0000

ADMINISTRATION

AUTHORIZATION TO SEEK BIDS

DATE: February 14, 2013

FROM: Fire Department

Craig J. Wainio
City Administrator

Staff is seeking authorization to advertise and seek bids for the disposal of the 1988 fire engine that is being taken out of service. Once bids are received, they will be presented to the City Council for final approval.

COUNCIL LETTER 021913-IX

PERSONNEL COMMITTEE

CLOSED MEETING

DATE: February 14, 2013

FROM: Personnel Committee

Craig J. Wainio
City Administrator

The City Council may go into Closed Session to discuss the negotiation being under taken with management personnel. The meeting is being closed pursuant to 2012 Minnesota Statutes 13D.03

The following provisions of State Statute must be observed:

- Before closing the meeting, the council must decide to close the meeting by a majority vote at a public meeting and must announce the time and place of the closed meeting.
- Before closing the meeting, the council must state on the record the specific grounds permitting the meeting to be closed and describe the subject to be discussed.
- A written record of all people present at the closed meeting must be available to the public after the closed meeting.
- The meeting must be tape-recorded.
- The recording must be kept for two years after the contract is signed.
- The recording becomes public after all labor agreements are signed by the city council for the current budget period.



Jamet L. Homaley for

Burl Haar, Executive Secretary



**MINNESOTA
DEPARTMENT OF
COMMERCE**

Minnesota Public Utilities Commission
121 7th Place East, Suite 350
St. Paul, Minnesota 55101-2198
ph 651.296.7124 | fx 651.297.7073
www.puc.state.mn.us

Energy Facility Permitting
85 7th Place East, Suite 500
St. Paul, Minnesota 55101-2198
ph 651.296.4026 | fx 651.297.7891
www.mn.gov/commerce/energyfacilities

NOTICE OF PUBLIC INFORMATION AND ENVIRONMENTAL ASSESSMENT SCOPING MEETINGS

Issued: February 4, 2013

**In the Matter of the Application of Minnesota Power for a Route Permit for the 39 Line 115
Kilovolt High Voltage Transmission Line (HVTL) Project in St. Louis County**

PUC Docket Number: E015/TL-12-1123

Minnesota Power has submitted a Route Permit Application to the Minnesota Public Utilities Commission (Commission) for its proposed 39 Line 115 kilovolt (kV) High Voltage Transmission Project (or 39 Line Reroute Project).

The Commission will conduct a public information and environmental assessment (EA) scoping meeting jointly with the Minnesota Department of Commerce Energy Facility Permitting unit (DOC EFP) on the 39 Line Reroute Project at the times and locations listed below.

The purpose of the meeting is to provide information to the public about the state's high-voltage transmission line route permitting process and the proposed project. Following brief presentations by Commission staff and DOC EFP staff, members of the public will have an opportunity to ask questions, provide comments, and identify potential impacts and route alternatives to be considered in the scope of the EA.

PUBLIC INFORMATION AND SCOPING MEETINGS

Monday, February 25, 2013

Afternoon Session – 2:00pm

Evening Session – 6:00pm

Leonidas Community Center

141 2nd Street North

Eveleth, MN 55734

Each public meeting will offer the same information.
Interested persons need attend only one meeting.

**Comments on the scope of the Environmental Assessment will be accepted until 4:30pm on
Monday, March 11, 2013.** Please include the Commission's docket number in all communications.

Comments should be mailed, emailed, or faxed to:

Bill Storm, Environmental Manager
Minnesota Department of Commerce – Energy Facility Permitting
85 7th Place East, Suite 500 | St. Paul, Minnesota, 55101-2198
Fax: 651-297-7891 | email: bill.storm@state.mn.us

Comments may also be submitted on the DOC EFP website: <http://mn.gov/commerce/energyfacilities>.

Project and Process Information

Project Description: Minnesota Power proposes to construct an approximate 3.0-mile-long, 115 kV high voltage transmission line (HVTL) in St. Louis County, near the city of Eveleth. Minnesota Power would also, at the request of United Taconite, remove approximately 1.9 miles of the existing 39 Line that runs through United Taconite's north pit.

Review Process: Minnesota Statute § 216E.03 provides that no person may construct a high voltage transmission line without a Route Permit from the Public Utilities Commission (Commission). The application is being processed under the Alternative Permitting Process outlined in Minnesota Rules 7850.2800-3900. The Alternative Process allots the Commission six months to reach a final decision on the route permit application from the date of the formal application acceptance (in this case, January 16, 2013). The Commission may extend this deadline for up to three months.

Information and Scoping Meeting: The purpose of these meetings is to provide information to the public about the project and to provide an opportunity for the public to comment on issues and alternatives to study in the EA that will be prepared by the DOC EFP staff.

Environmental Document: The DOC EFP will solicit public comments at this meeting on the scope of the EA. The purpose of the EA is to provide information on the potential human and environmental effects of the proposed project, discuss possible alternative routes or route segments (if any), and examine potential mitigating measures for anticipated effects.

Public Hearing: Following the release of the EA a public hearing will be held. Members of the public will have an opportunity to speak at the hearing, present evidence, ask questions, and submit comments. Notice of the public hearing will be published in local newspapers and mailed to persons who register on the Project Contact List, below.

Upon completion of the environmental review and hearing process, the Commission will make a final decision on whether to issue a route permit to Minnesota Power.

Eminent Domain: If issued a route permit by the Commission, the Applicant may exercise the power of eminent domain to acquire land for this project pursuant to Minnesota Statute § 216E.12.

How to Learn More About the 39 Line Project

Project Mailing List: Persons may contact the Environmental Manager or Public Advisor (noted below) or visit <http://mn.gov/commerce/energyfacilities/> to sign up for the Project Contact List. Persons on the mailing list will receive notices of meetings and notices of document availability for this project. **If you do not sign up for the mailing list you will not receive correspondence about this project after this notice.** Signing up for the project mailing list is voluntary and may be done at any time.

Full Case Record: All documents filed in this docket are available on the Commission's website at www.puc.state.mn.us, select "Search eDockets," enter the year (12) and the docket number (1123), select "Search."

DOC EFP Project Webpage: <http://mn.gov/commerce/energyfacilities/Docket.html?Id=32972>

Subscribe to the Docket: Receive notification when new documents are filed in this docket at www.puc.state.mn.us, select "Subscribe to a Docket," and follow the prompts.

Public Libraries: The route permit application is available at the following public libraries:

Eveleth Public Library 614 Pierce Street Eveleth, MN 55734 218.744.7499	Mountain Iron Public Library 8586 Enterprise Drive South Mountain Iron, MN 55768 218.735.8625
--	--

Project Contacts

Commission Public Advisor: Tracy Smetana | consumer.puc@state.mn.us |
Phone: 651-296-0406 or 1-800-657-3782.

Commission Staff Analyst: Tricia DeBleekere | tricia.debleeckere@state.mn.us |
Phone: 651-201-2254

DOC EFP Environmental Manager: Bill Storm | bill.storm@state.mn.us |
Phone: 651-296-9535 | Toll-Free: 1-800-657-3794 | Fax: 651-297-7891

Minnesota Power Project Contact: Daniel McCourtney, dmccourtney@allete.com |
Phone: 218-355-3515

This document can be made available in alternative formats (e.g., large print or audio) by calling 651-296-0406 (voice). Persons with hearing loss or speech disabilities may call us through Minnesota Relay at 1-800-627-3529 or by dialing 711.

If any reasonable accommodation is needed to enable you to fully participate in these public meetings (e.g. sign language, foreign language interpreter, large print materials), please contact the Commission at 651-296-0406 or 1-800-657-3782 one week in advance of the hearing.